

# Removable Anchor

Structural Concrete



**GEMTOR**<sup>™</sup>

*...when your life is on the line<sup>™</sup>*

One Johnson Avenue  
Matawan, NJ 07747

Phone: 800-405-9048

Fax: 732-290-9391

Email: [sales.info@gemtor.com](mailto:sales.info@gemtor.com)

[www.gemtor.com](http://www.gemtor.com)

## Concrete Hole Anchor

Gemtor's Model #CHA-34 Concrete Hole Anchor is constructed of lightweight aluminum and stainless steel. The unique quick release design allows the anchor to be immediately removed where other types require more time and tools or become embedded in the concrete resulting in them being chiseled out and damaging the deck.

It is designed to easily accommodate a locking carabiner or compatible snap hook. All components are **Made in the USA**.

### Features

- ☑ Easy to install and remove.
- ☑ Non-corrosive device with chocks and wedge fabricated from high quality stainless steel.
- ☑ 5,000 pound anchorage point.
- ☑ Security Assurance: The anchor can be set as hard as desired without fear of becoming stuck in the hole, allowing improved worker mobility.
- ☑ No more hunting for tools to remove a stuck anchor.
- ☑ Compact, lightweight and dependable (weighs 9 ounces).
- ☑ Snaphook or carabiner compatible attachment point.
- ☑ Securely attached identification label.
- ☑ Reusable\*.

\* Device shall be inspected before and after each use by a qualified person. In the event of a fall, all associated devices (harness, lanyard, etc.) must be inspected.

### Available Models

**CHA-34** – Concrete Hole Anchor designed for use in concrete decks utilizing a 3/4" hole.

### Complementary Components

**SRL Series** – Self Retracting Lifelines available in 30 foot, 50 foot and 65 foot lengths. Available with galvanized or stainless steel cable. Weights from 16 to 27 pounds.

**SL2 Series** – Self Retracting Lifelines with lightweight aluminum housing. Choose from 30, 50 or 100 foot lengths. Available with galvanized or stainless steel cable. Weights from 20 to 45 pounds.

**SWL Series** – Self Retracting Polyester Web Lifelines with steel housing available in 20 foot and 30 foot lengths. Weights 12 (20') or 14 1/2 (30') pounds.

**FLW Series** – Self Retracting Lanyard supplied with 10 feet of polyester or Technora webbing. Weights 2 3/4 pounds.

**RL8** – Self Retracting Lanyard with 8 feet of 1 3/4" wide polyester webbing. Weights 2 3/4 pounds.

**Carabiners** – A wide variety of carabiners are available for use as connectors.

**Snap Hooks** – A full array of snap hooks in many configurations are available.

**Harnesses** – Gemtor produces a full line of harnesses to meet your specific needs.

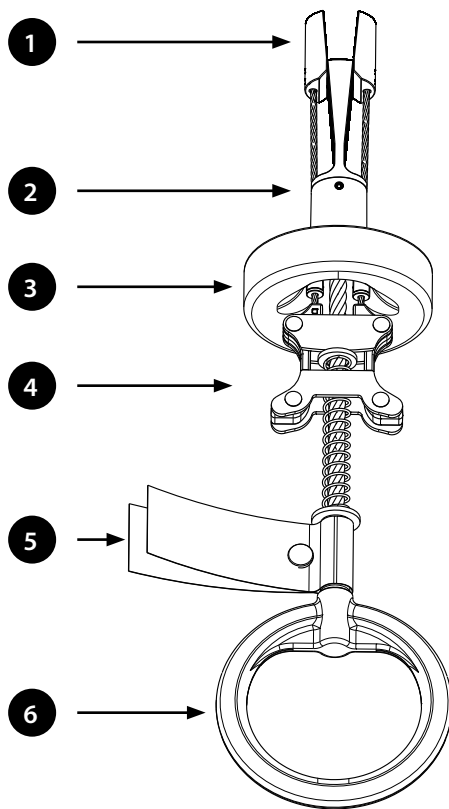

1. Forged stainless steel chocks and wedge.
2. Stainless steel pin secures the Release Button to the wedge for a dependable chock release.
3. Load cable and chock release cables are shielded from damage caused by abrasion against the hole drilled in the concrete. Pushing the Release Button towards the deck and lifting the Retractor Handle allows for easy removal of the device.
4. The exclusive pivoting Retractor Handle prevents cable kinking.
5. Product Information Label.
6. Connection Point compatible with locking Carabiners and Snaphooks.

US Patent #7258316. Other US and Foreign Patents Pending.

Meets or exceeds all applicable standards including OSHA 1926.502 and ANSI Z359.1-2007 and A10.32-2004

### Usage

Follow all manufacturer's instructions. For **FALL PROTECTION ONLY**. For use in concrete substrate only. **DO NOT** use in wet or uncured concrete. Concrete must have 3,000 PSI minimum compressive strength. Always inspect prior to use. For use by qualified fall protection personnel only. Never use ladder scaffold or rebar hooks unless they are designed for this type of connection. Use only compatible connectors, snaphooks or carabiners with this unit. This unit is not to be used for any other type of anchoring situation. Anchor is rated at 5,000 pounds for a single user of up to 310 pounds. Do Not use in steel, wood, or any substrate other than the specified concrete.

### Inspection

Make sure unit is straight and operates smoothly. Make sure the label is affixed to the unit. Make sure the retractor handle is not bent or damaged. Make sure the retractor cables are not kinked, frayed or damaged. Make sure metal components are not damaged. Make sure chocks and wedge operate smoothly and no metal burrs are present. When reusing a previously drilled hole, always inspect the hole carefully.

Your Authorized Gemtor Distributor:



**GEMTOR**



... when your life is on the line™

Gemtor, Inc. • 1 Johnson Avenue • Matawan, NJ 07747

Phone: 800-405-9048 • Fax: 732-290-9391

www.gemtor.com